



Broken Hill
Art Exchange

BROKEN HILL ART EXCHANGE
PO BOX 1083
BROKEN HILL
NSW 2880 AUSTRALIA

PH:+61 8 8088-3171
ABN: 33 892 538 379

www.brokenhillartexchange.org.au
info@brokenhillartexchange.org.au

A transdisciplinary approach to Art

BROKEN HILL ART EXCHANGE AT THE GRAND

RESIDENCY PROGRAM APPLICATION FORM

*The **Broken Hill Art Exchange Inc.** is a not for profit, volunteer and artist run organisation. Supporting the production of art and the progress of artists, it aims to advance art and culture within communities. **BHAE** encourages transdisciplinary approaches to art through engagement between different sectors such as Health, Education, Environmental Studies, and Science.*

***BHAE's** base is located at 313 Argent Street, Broken Hill, in a re-tasked heritage-listed guesthouse (circa 1888) and has been providing short and long-term residency to individuals and groups engaged in arts since its inception in 2001. **BHAE** has hosted numerous Australian and international painters, writers, film producers, musicians, designers and academics, among others.*

*Australia's only Heritage City, **Broken Hill**, continues to inspire creative minds through its unique outback landscape, remoteness, spellbinding sky and the genuine friendliness of its people. You are bound to hear and take away many fascinating stories if you stay awhile...*

BROKEN HILL ART EXCHANGE - RESIDENCY APPLICATION

SECTION 1 - APPLICANT DETAILS

**IF YOU ARE
APPLYING AS AN
REPRESENTATIVE FOR
OTHER/S
PLEASE COMPLETE THIS
SECTION**

Agent's full name

Name of your Organisation

Please note that you will be the main contact for official correspondence, invoicing, etc.

Address of Organisation

City

State

Postcode

Country

Email

Phone (incl area / country code)

APPLICANT DETAILS

Print title and full name

**IS THIS APPLICATION FOR A
GROUP?**

**Please circle
YES or NO**

IF "YES" Please note that you will be the main point of contact for BHAЕ during your stay and for all correspondence. Please ensure that all group members are included in [section 3](#)

Your Address

City

State

Postcode

Country

Email

Phone (incl area / country code)

CONTINUE TO SECTION 2

SECTION 2 - RESIDENCY DETAILS

Please indicate the nature of your residency by marking an X in the space provided

SECTOR / PRACTISE
(please provide details - visual art, music, poetry, Health, Education, Science, etc)

The Broken Hill Art Exchange produces Seasonal Almanacs based on four elemental themes. Prospective residents must choose the theme best suited to their application irrespective of their proposed residency dates.

Please indicate in the box below

| | | | |
|-----------------|------|-------|-------|
| SOLAR (fire) | WIND | EARTH | WATER |
| | | | |

| | |
|---|--|
| COMMUNITY DEVELOPMENT. For applicants intending to engage local communities through a specific project (e.g., conducting workshops) | <input style="width: 80%; height: 40px;" type="checkbox"/> |
|---|--|

| | |
|---|--|
| COMMUNITY DEVELOPMENT. For applicants intending to engage local communities through a specific project (e.g., conducting workshops) | <input style="width: 80%; height: 40px;" type="checkbox"/> |
|---|--|

| | |
|---|--|
| INDUSTRY DEVELOPMENT. (NB. Minimum 3 months) For applicants interested in: * Volunteering at the Broken Hill Art Exchange Inc. or * Developing cottage industries / social enterprises at the Southside Art Centre (BHAЕ's annexe) | <input style="width: 80%; height: 40px;" type="checkbox"/> |
|---|--|

| | |
|---------------------|--|
| ARRIVAL DATE | <input style="width: 95%; height: 40px;" type="text"/> |
|---------------------|--|

| | |
|-----------------------|--|
| DEPARTURE DATE | <input style="width: 95%; height: 40px;" type="text"/> |
|-----------------------|--|

| | |
|---|--|
| TOTAL NUMBER OF NIGHTS YOU WILL BE STAYING | <input style="width: 95%; height: 40px;" type="text"/> |
|---|--|

CONTINUE TO SECTION 3

SECTION 3 - GENERAL DETAILS

IF THIS APPLICATION IS FOR A GROUP PLEASE ENSURE YOU ARE AWARE OF THE
CONDITIONS FOR SINGLE AND SHARED ROOM BOOKINGS.
(Please refer to section 5 for accommodation details)

Please insert the full name of each
group member accompanying you,
and their role.

Eg, John Smith - Actor

| |
|--|
| |
| |
| |
| |
| |
| |

IF MORE SPACE REQUIRED PLEASE CHECK THIS SPACE AND ATTACH LIST TO YOUR APPLICATION

DOCUMENTATION

Where copies are required please
forward **ONLY** digital copies: PDF,
JPG, etc.
Please limit size of attachments to
5mb

PLEASE PROVIDE AS ATTACHMENTS:

Your CV and/or biography

A maximum of 4 samples of your artistic work where
applicable

URL of uploaded work if available. Include your website
address if you have one. (Eg, YouTube, Vimeo, etc)

| |
|--|
| |
|--|

**PLEASE
PROVIDE 2
REFEREES**

Name

Ph. Incl country & area code

Name

Ph. Incl country & area code

FUNDING: Please indicate how your residency fees will be funded by placing 'X' in the relevant
box and providing details where required.

SELF FUNDED

GRANTS

OTHER

Please provide the full name(s) of the grant(s) or other funding source(s):

CONTINUE TO SECTION 4

SECTION 4 - YOUR RESIDENCY PROJECT

PROJECT TITLE

PROJECT DESCRIPTION (in 200 words or less)

SPECIAL REQUIREMENTS if applicable

Special service/s required
(eg Local project management)

Special equipment required

NB - BHAЕ cannot guarantee supply or access to equipment or special services

CONTINUE TO SECTION 5

SECTION 5 - RESIDENCY FEES

All residences are located at BHAЕ's facilities in Broken Hill, New South Wales, Australia. Residency fees are in Australian dollars. All residency fees are subsidised by BHAЕ. Rooms and apartments can be booked as single or shared, but shared bookings will not be accepted for guests from separate parties/groups without express permission from all booking parties. The Duff Street Annexe has a fixed weekly fee whether booked as shared or single accommodation.

PLEASE NOTE - A non-refundable 50 % deposit is required upon acceptance of your residency application

APARTMENT ROOMS: Room with en-suite bathroom and access to a work space, accommodating up to 2 people, with 2 Single beds

| | | | | |
|--|---|------------------|------------------|------------|
| <p>A non-refundable deposit of 50% is to be paid upon residency acceptance. Balance payment is to be made prior to departure or on a weekly basis (for longer stays).</p> <p>Fees are calculated on a weekly tariff only and are applicable for all nights up to 7 days.</p> <p>Single occupancy weekly fee: \$250 / 7 days Shared occupancy weekly fee: \$350 / 7 days</p> | <p style="text-align: center;">WEEKLY SINGLE \$250 per wk (7 days)</p> | Number of ROOMS? | Number of weeks? | TOTAL COST |
| | <p style="text-align: center;">WEEKLY SHARE \$350 per wk (7 days)</p> | Number of ROOMS? | Number of weeks? | TOTAL COST |

ROOMS: Room and workspace accommodating up to 2 people per room (bunk style)

| | | | | |
|--|--|------------------|------------------|------------|
| <p>A non-refundable deposit of 50% is to be paid upon residency acceptance. Balance payment is to be made prior to departure or on a weekly basis (for longer stays).</p> <p>Fees are calculated on a weekly tariff only and are applicable for all nights up to 7 days.</p> <p>Single occupancy weekly fee: \$190 / 7 days Shared occupancy weekly fee: \$265 / 7 days</p> | <p style="text-align: center;">WEEKLY SINGLE \$190 per wk 7 nights</p> | Number of ROOMS? | Number of weeks? | TOTAL COST |
| | <p style="text-align: center;">WEEKLY SHARE \$265 per wk (7 nights)</p> | Number of ROOMS? | Number of weeks? | TOTAL COST |

DUFF STREET ANNEXE: Located at 145-157 Duff Street Broken Hill (Southside), 4 self contained studio units that can accommodate up to 4 people each.

| | | |
|---|------------------|------------|
| <p>A non-refundable deposit of 50% is to be paid upon residency acceptance. Balance payment is to be made prior to departure or on a weekly basis (for longer stays).</p> <p>Fees are calculated on a weekly tariff only and are applicable for all nights up to 7 days.</p> <p style="text-align: center;">\$300 / week</p> | Number of weeks? | TOTAL COST |
|---|------------------|------------|

Under special circumstances a 10% concession may apply
Please contact BHAЕ to discuss your application.

BROKEN HILL ART EXCHANGE AT THE GRAND LAYOUT

BHAE has workspaces / studios available for hire.

Please contact the project team to ascertain availability.

Please note: The Kitchen Gallery, Saddlery and Sample Rooms are on the ground floor, accessible from the courtyard

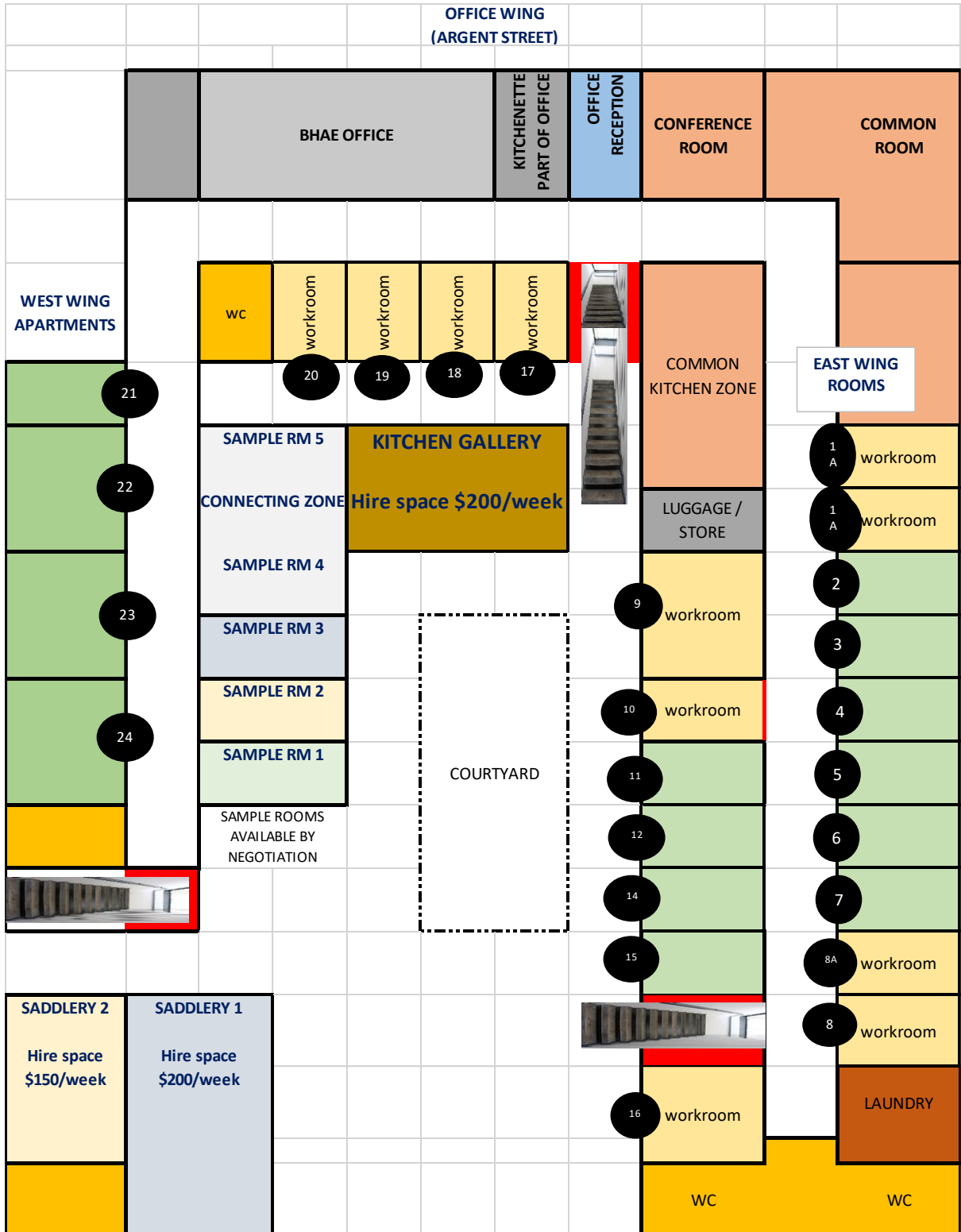

SECTION 6 - CONFIRMATION & DECLARATION

Please indicate that you have provided digital copies of the following documents by marking the applicable box

CURRICULUM VITAE

And / Or

BIOGRAPHY

With

JPEG SAMPLES OF MY WORK

And

If applying for a 10% concession
COPY OF A VALID CONCESSION CARD

I confirm that I have filled all sections of this application form to the best of my ability.

As Artist in Residence I agree to acknowledge the Broken Hill Art Exchange in projects developed as an outcome of my /our residency.

I agree to comply with the Terms and Conditions applicable to my residency at the Broken Hill Art Exchange.

APPLICANT'S SIGNATURE

SIGNATURE _____

FULL NAME (Please print): _____

DATE: _____

Thank you for applying to the Broken Hill Art Exchange Residency Program.

You will be notified once your application has been processed.

Please return this form by post or email to:

Broken Hill Art Exchange Inc. PO Box 1083, Broken Hill NSW AUSTRALIA 2880

Email: info@brokenhillartexchange.org.au

Telephone: + 61 8 8088-3171

SECTION 7 - ARTIST IN RESIDENCE PROFILE

The information requested below is used by BHAЕ to promote and publicise your residency, and the artist residency program in general. Your project title and description, as well as your profile may be used in BHAЕ's website, publications and catalogues. BHAЕ will not reproduce details of a personal nature, but by completing this questionnaire you accept that material provided may be used.

TELL US A LITTLE ABOUT YOURSELF:

TELL US ABOUT YOUR WORK:

WHAT INSPIRES YOU?:

WHAT ATTRACTS YOU TO BROKEN HILL?:

WHAT DO YOU HOPE TO EXPERIENCE IN BROKEN HILL?:

| Office use only: | | | | | | |
|------------------|------------|----------|--------------|-----------|-------------|---------------------|
| RECEIVED | | | NOTIFIED | | | RECEIPT / INVOICE # |
| DEPOSIT y/n | | | BAL RECEIVED | | | |
| CV/BIO | REFERENCES | SAMPLES | CONCESSION | DISCOUNTS | TOTAL OWING | ALLOCATION |
| YES / NO | YES / NO | YES / NO | YES / NO | YES / NO | | |

BROKEN HILL ART EXCHANGE RESIDENCY TERMS AND CONDITIONS

If you have any questions about our residency program, please contact us before making your application.

1. Terms of Booking & Booking Deposit

1. By placing a residency application with us (Broken Hill Art Exchange Inc.) you (the lead guest) and your booking party (guests) agree to the following terms and conditions as set-out. During your stay you agree to abide by the subsequent conditions as set-out.
2. Where the person making the booking is different to the lead guest taking up the occupation, the person making the booking may be held responsible for cancellation, non-arrival and damages as set-out within. Only the lead guest and the named booking party are allowed to use the property and its facilities, any third party visitors are only allowed access at our express permission.
3. To secure any booking we require a deposit to be paid in advance, this deposit amount is 50% of your residency accommodation fee. **This deposit is non-refundable.**
4. Deposit payments must be 'cleared funds' before a booking can be confirmed. Deposits are only refundable under the conditions set-out here within.
5. Payments can be made by digital bank transfer, cheque or cash deposit. Any charges raised against us by our banks for handling dishonoured cheque's, bank transfers or any other payments, must be reimbursed by the lead guest within seven (7) days of any request to do so.
6. All guests agree to respect the privacy and peace of all other staying guests, neighbours and the owners at all times. We reserve the right to cancel a booking with immediate effect if guests are not honouring this agreement or causing a disturbance / nuisance to other guests, neighbours or the owners.

2. Room & Apartment occupancy

1. Rooms contain double bunks and can be booked as "single" or "shared" for the duration of your stay. "Shared" bookings will not be accepted without the express permission of all booking parties or group members.
2. Apartments contain two single beds and can be booked as "single" or "shared" for the duration of your stay. "Shared" bookings will not be accepted without the express permission of all booking parties or group members.
3. The Duff Street Annexe units have a fixed fee whether booked as shared or single accommodation.
4. **"Shared" occupancy cannot be specified and/or booked for a single guest occupant.**

3. Check-in & Check-out

1. Guests must check-in and check-out by the times stated below;
 - Check-in from: 2.00pm and before 3:00pm on day of arrival
 - Early, Late or after-hours check in will only be accepted by prior notification.
 - Check-out by: 10:00am on day of departure
 - Late check-out will only be considered upon prior notification

4. Cancellation, Deposits & Non-Arrival Conditions

1. Deposits made are non-refundable.
2. Non-arrival guests, who are unable to attend or fail to attend for whatever reason forfeit their deposit paid and the full amount of the booking will be due.
3. In the rare event we need to cancel your booking with us, please be aware that we cannot be held liable for circumstances beyond our control and that our liability to you is limited to the refund of any payment already made.

5. WiFi Fair & Appropriate Usage Policy

1. Where WiFi Internet access is provided, guests accept to use this access to the Internet fairly and appropriately. We may monitor network performance and user usage in order to maintain a fair and high level of service to all our guests.
2. The Internet access provided is intended for general use such as access to the world wide web, email, messaging, social media, light video / music / media streaming. It is not intended or ideally suited for heavy media streaming, online gaming, extensive downloads / uploads. Access to illegal activity or use of our network for illegal activity is prohibited and will be reported to authorities.

6. Damages & Lost Property

1. We reserve the right to charge the lead guest for any damages caused through the course of a booking by any member of the booking party. This includes breakages, spillages, stains, damage to furniture or fixtures and fittings. Any accidental damages should be reported as soon as possible in order to minimise damage and associated costs.
2. **Lost keys / fobs / access cards will incur a replacement charge per key / fob / card lost of \$50.00.**
3. Any lost property, if discovered and found, left behind by guests during a stay will be held for a period of 1 month. While we will make our best efforts to reunite lost property with their owners we accept no responsibility in replacing lost items and encourage guests to ensure they have all their belongings before checking-out.
4. While Broken Hill Art Exchange exercises all reasonable care and security it accepts no responsibility for loss, theft or damage of guest belongings.

7. Smoking

1. Smoking of any kind is not permitted anywhere within the Residence, Galleries, workspaces and workshops **except** in designated areas as advised by management.

8. Pets & Service Dogs

1. We do not accept pets throughout the accommodation, except for service dogs.

9. Parking

1. Where parking is provided guests accept that they park their vehicles at their own risk.

10. Our Right To Cancellation

1. We reserve the right to cancel any booking without compensation, refund or reimbursement if the terms of these conditions are breached.